

Inserts

General turning

Aluminium wheel turning

Automatic lathes

Ceramic tools

Parting and grooving

Threading

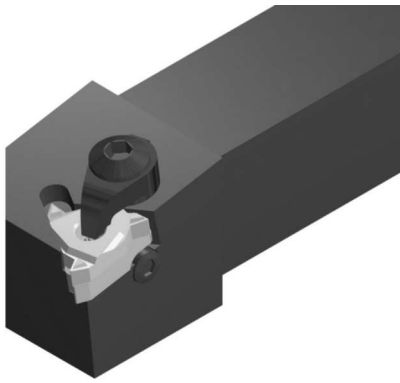

### Characteristics:

Top clamp threading toolholder for negative lay down inserts.  
The insert is positioned a  $-10^\circ$  cutting angle, and a  $-1^\circ$  clearance angle.

### Applications:

Multipurpose threading toolholders.

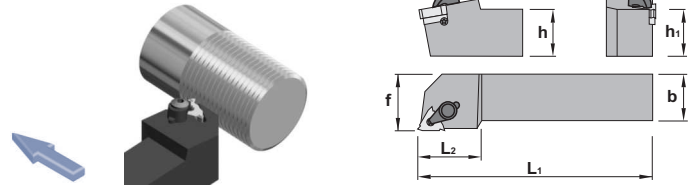

## CTXN 90°

Ref.		h=h <sub>1</sub>	b	L <sub>1</sub>	L <sub>2</sub>	f	Insert size	Kg
Ref.	CTXN R/L 1212 F16	12	12	80	22,0	16	16 ER/L..	0,100
	CTXN R/L 1616 H16	16	16	100	20,5	20	16 ER/L..	0,200
	CTXN R/L 2020 K16	20	20	125	30,0	25	16 ER/L..	0,400
	CTXN R/L 2525 M16	25	25	150	30,0	32	16 ER/L..	0,700
	CTXN R/L 3232 P16	32	32	170	30,0	40	16 ER/L..	1,050
	CTXN R/L 2525 M22	25	25	150	36,0	32	22 ER/L..	0,700
	CTXN R/L 3232 P22	32	32	170	36,0	40	22 ER/L..	1,300
	CTXN R/L 4040 R22	40	40	200	36,0	50	22 ER/L..	3,000
	CTXN R/L 2525 M27	25	25	150	35,0	32	27 ER/L..	0,700
	CTXN R/L 3232 P27	32	32	170	40,0	40	27 ER/L..	1,300
CTXN R/L 4040 R27	40	40	200	40,0	50	27 ER/L..	3,000	
CTXN R/L 5050 S27	50	50	250	40,0	60	27 ER/L..	5,800	

Ref.							
Ref.	CTXN R/L 1212 F16	2516	5515	YE3	YI3	SY3	SA3
	CTXN R/L 1616 H16	2516	5515	YE3	YI3	SY3	SA3
	CTXN R/L 2020 K16	2516	5515	YE3	YI3	SY3	SA3
	CTXN R/L 2525 M16	2516	5515	YE3	YI3	SY3	SA3
	CTXN R/L 3232 P16	2516	5515	YE3	YI3	SY3	SA3
	CTXN R/L 2525 M22	2522	5515	YE4	YI4	SY4	SA4
	CTXN R/L 3232 P22	2522	5515	YE4	YI4	SY4	SA4
	CTXN R/L 4040 R22	2522	5515	YE4	YI4	SY4	SA4
	CTXN R/L 2525 M27	2527	5525	YE5	YI5	SY5	SA5
	CTXN R/L 3232 P27	2527	5525	YE5	YI5	SY5	SA5
	CTXN R/L 4040 R27	2527	5525	YE5	YI5	SY5	SA5
	CTXN R/L 5050 S27	2527	5525	YE5	YI5	SY5	SA5

Optional

Ref.	E R/L		I	d	Negative triangular inserts for external threading
		16 ER/L..	22 ER/L..	27 ER/L..	
	ER/L	ER/L TD			

For more information see page: H.04