

- Inserts
- General turning
- Aluminium wheel turning
- Automatic lathes
- Ceramic tools
- Parting and grooving
- Threading

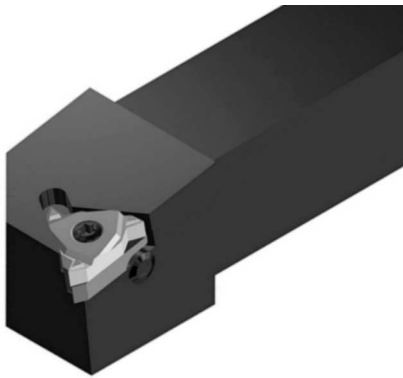

Characteristics:

Threading toolholder for negative lay down inserts.
The screw clamping ensures good stiffness and evacuation of chips.
The insert is positioned a -10° cutting angle, and a -1° clearance angle.





Applications:

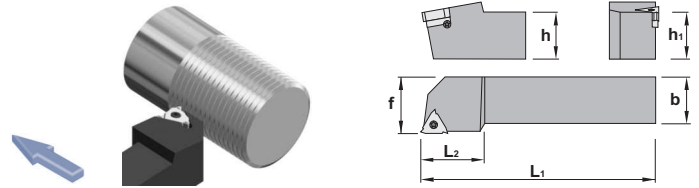

Multipurpose threading toolholders.

Metric screws



SXGN 90°		h=h₁	b	L₁	L₂	f	Insert size	kg
Ref.	SXGN R/L 1212 F16	12	12	80	22	16	16 ER/L..	0,100
	SXGN R/L 1616 H16	16	16	100	22	20	16 ER/L..	0,200
	SXGN R/L 2020 K16	20	20	125	28	25	16 ER/L..	0,400
	SXGN R/L 2525 M16	25	25	150	28	32	16 ER/L..	0,700
	SXGN R/L 3232 P16	32	32	170	28	40	16 ER/L..	1,050
	SXGN R/L 2525 M22	25	25	150	34	32	22 ER/L..	0,700
	SXGN R/L 3232 P22	32	32	170	34	40	22 ER/L..	1,050

Ref.			 R	 L	
SXGN R/L 1212 F16	1335	5515	3424	3425	1093
SXGN R/L 1616 H16	1335	5515	3424	3425	1093
SXGN R/L 2020 K16	1335	5515	3424	3425	1093
SXGN R/L 2525 M16	1335	5515	3424	3425	1093
SXGN R/L 3232 P16	1335	5515	3424	3425	1093
SXGN R/L 2525 M22	1340	5515	3430	3431	1094
SXGN R/L 3232 P22	1340	5515	3430	3431	1094

Ref.	E R/L		l	d	Negative triangular inserts for external threading
		16 ER/L..	22 ER/L..	16,00	
			22,00	12,70	
	ER/L	ER/L TD			
					

For more information see page: H.04